

Measure length of coupling band parallel to the centerline of the pipe

**STEEL PLATE**

**NOTE:**

1. Galvanize all pipe stakes and hardware after fabrication.
2. Approved alternative pipe anchor assemblies may be used.
3. Place slope anchor assemblies on 20' max. centers on slopes 20% or greater.
4. Plate material to be ASTM A36. Galvanize after fabrication.

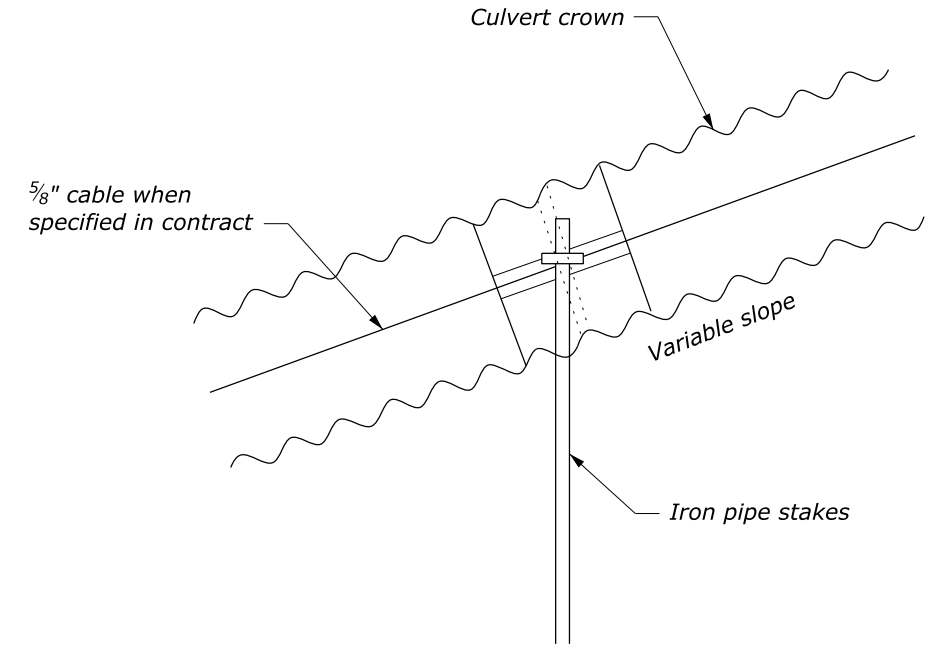

**METAL PIPE ASSEMBLY**

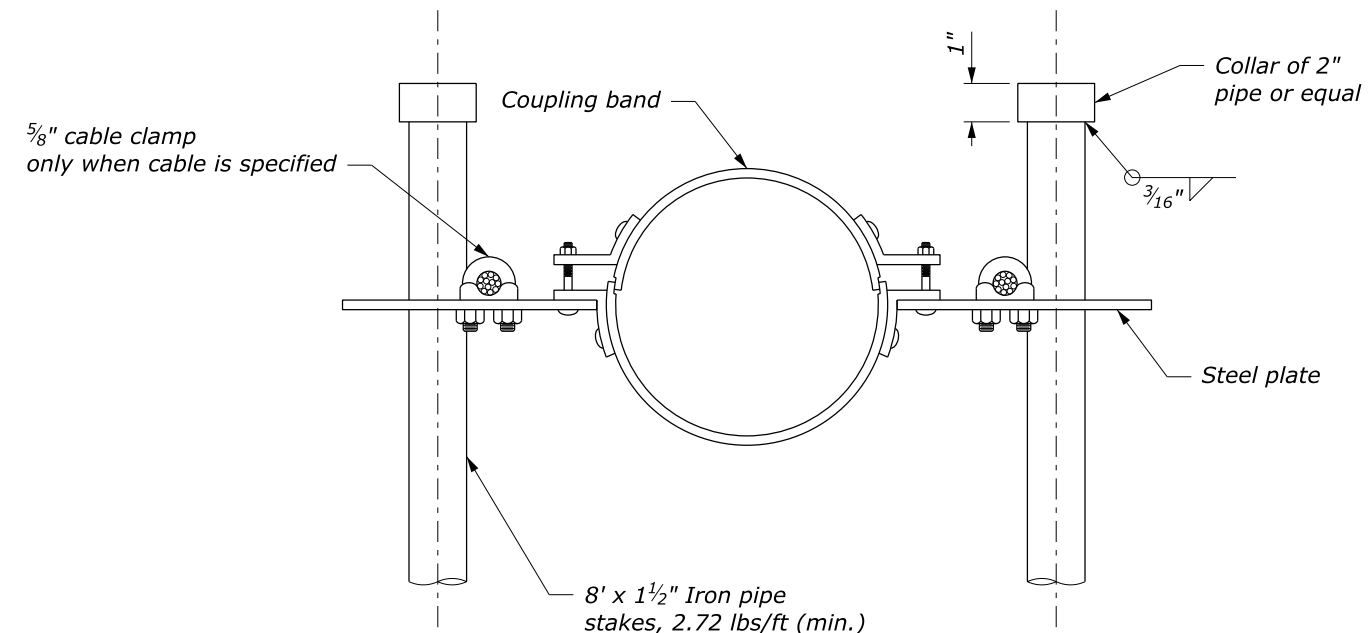

**ANCHOR ASSEMBLY**

NO SCALE

U.S. DEPARTMENT OF TRANSPORTATION, FHWA OFFICE OF FEDERAL LANDS HIGHWAY	WFLHD DETAIL W606-14
<b>PIPE ANCHOR ASSEMBLY</b>	SPECIFICATION FP-24, FP-14
	APPROVED FOR USE 9/2009

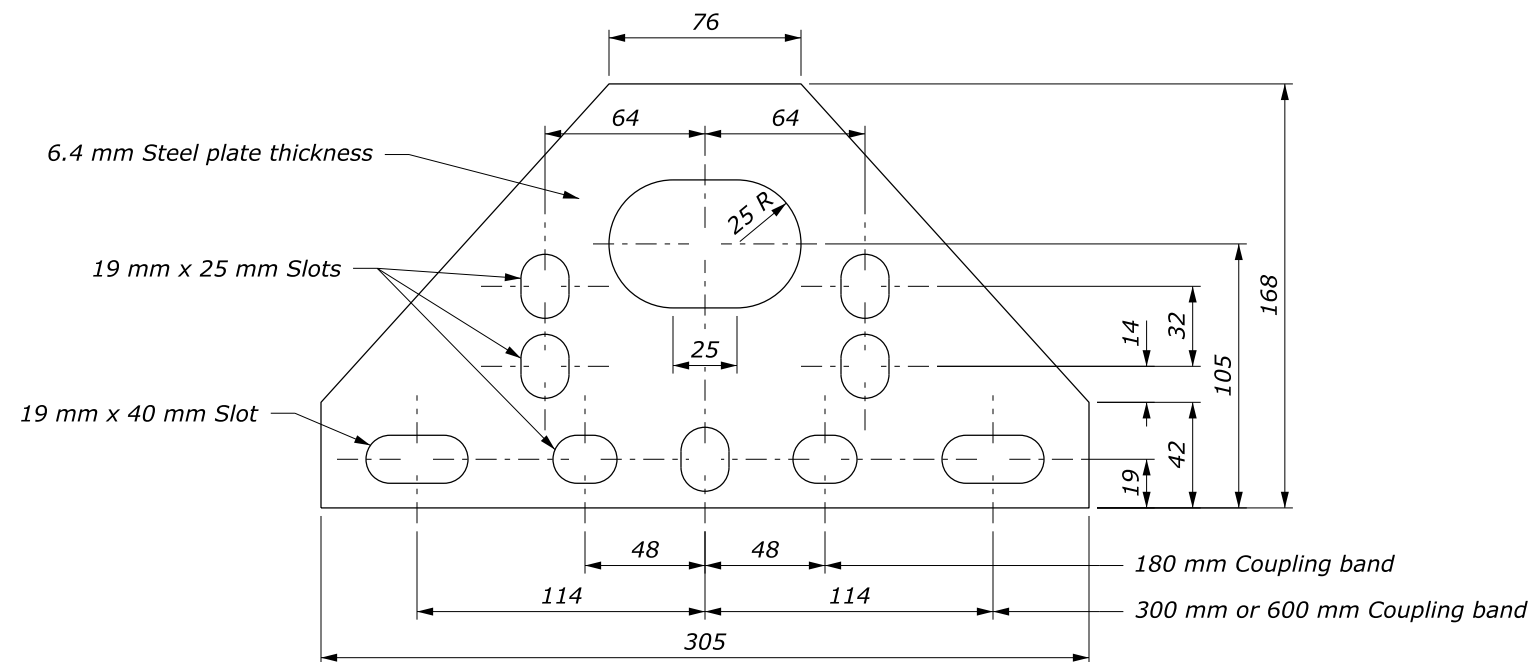

Measure length of coupling band parallel to the centerline of the pipe

**STEEL PLATE**

**NOTE:**

1. Galvanize all pipe stakes and hardware after fabrication.
2. Approved alternative pipe anchor assemblies may be used.
3. Place slope anchor assemblies on 6 m max. centers on slopes 20% or greater.
4. Plate material to be ASTM A36. Galvanize after fabrication.

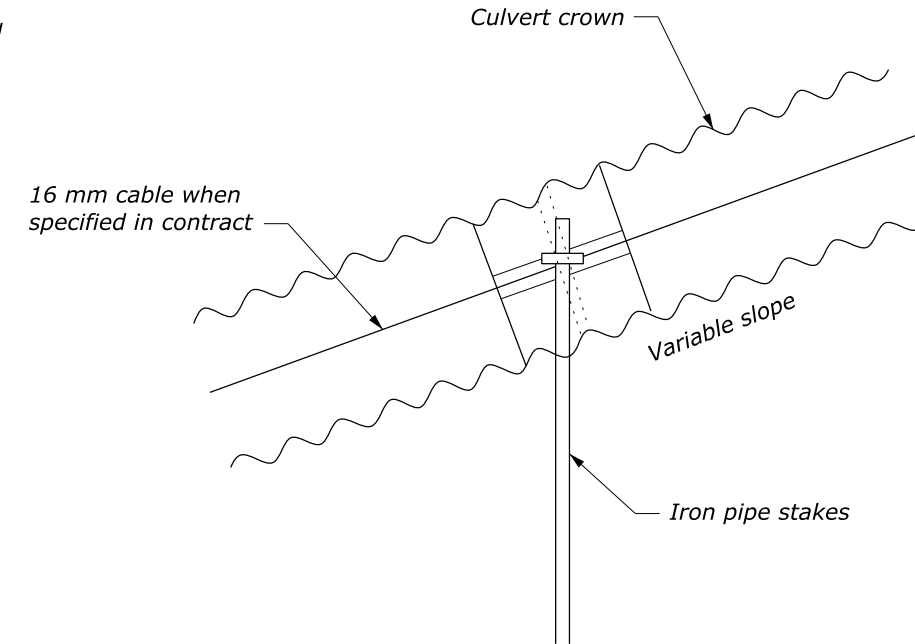

**METAL PIPE ASSEMBLY**

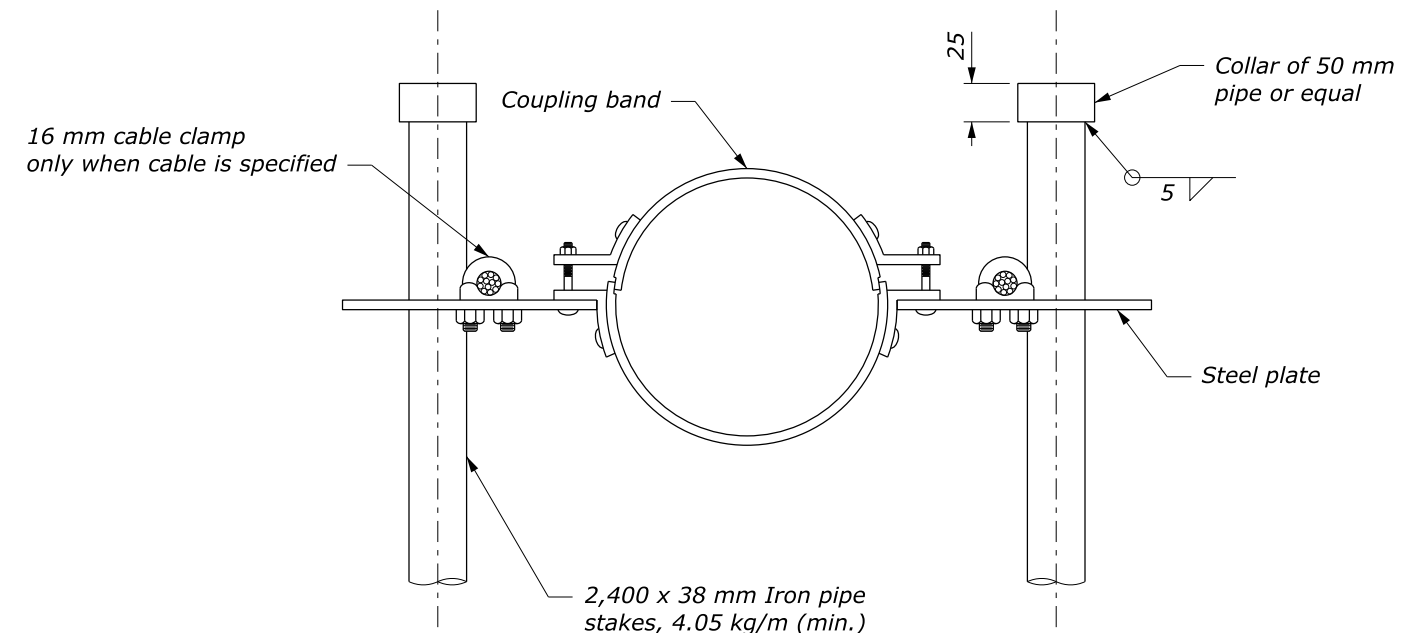

**ANCHOR ASSEMBLY**

This drawing contains **Metric** units of measure. Dimensions without units are millimeters.

U.S. DEPARTMENT OF TRANSPORTATION, FHWA OFFICE OF FEDERAL LANDS HIGHWAY	WFLHD DETAIL WM606-14
	SPECIFICATION FP-24, FP-14
APPROVED FOR USE 9/2009	

**PIPE ANCHOR ASSEMBLY**

NO SCALE