

WITHOUT SHOULDER

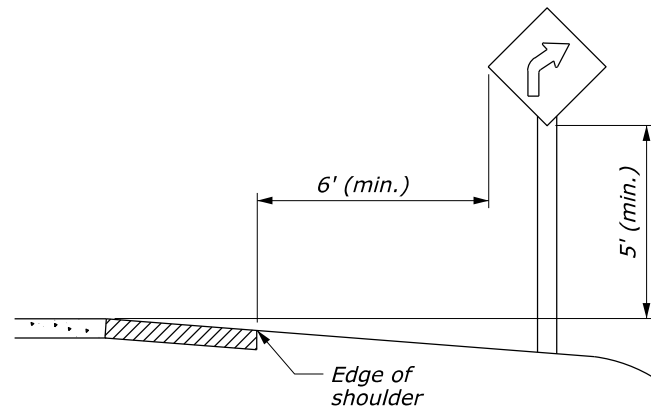

WITH SHOULDER

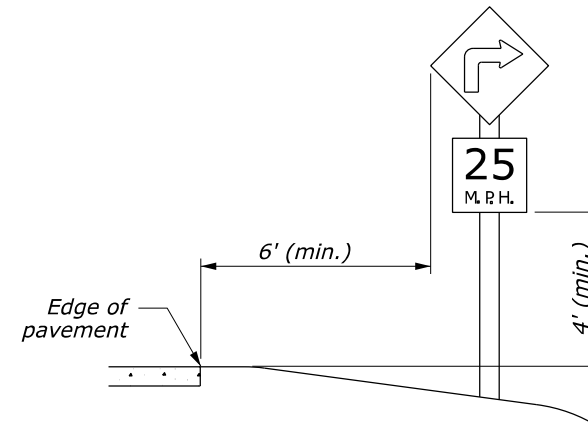

WITH ADVISORY SPEED PLAQUE

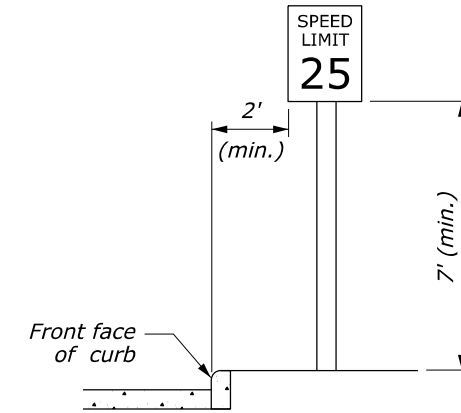

ROADSIDE SIGN IN BUSINESS OR RESIDENTIAL DISTRICT

**ROADSIDE SIGN IN RURAL DISTRICT**

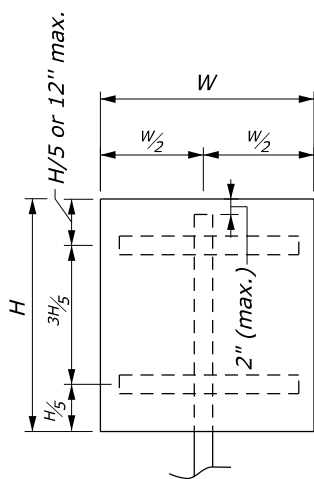

SINGLE POST

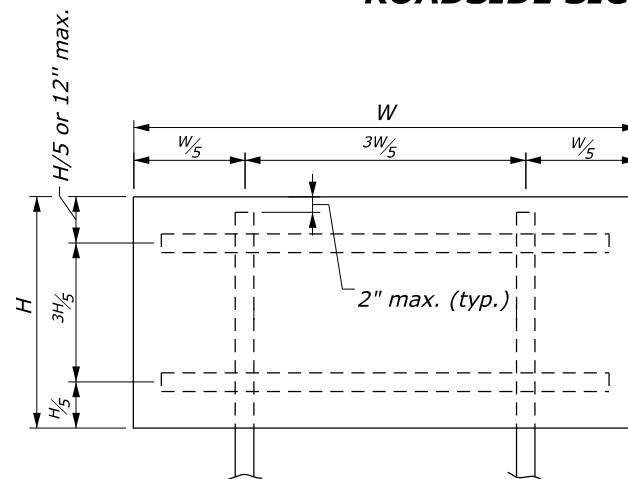

DOUBLE POST

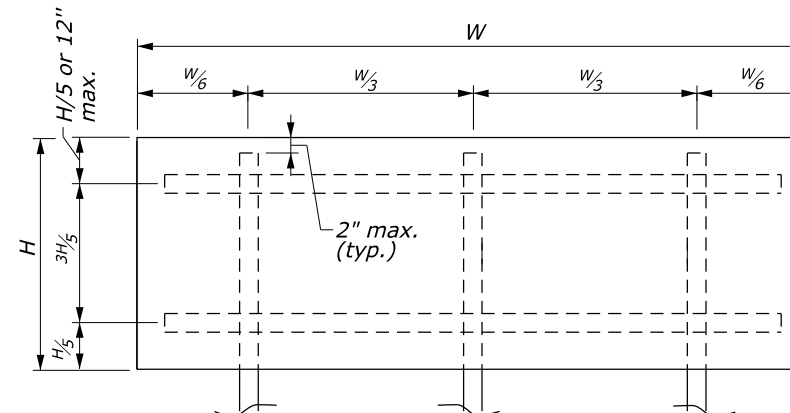

TRIPLE POST

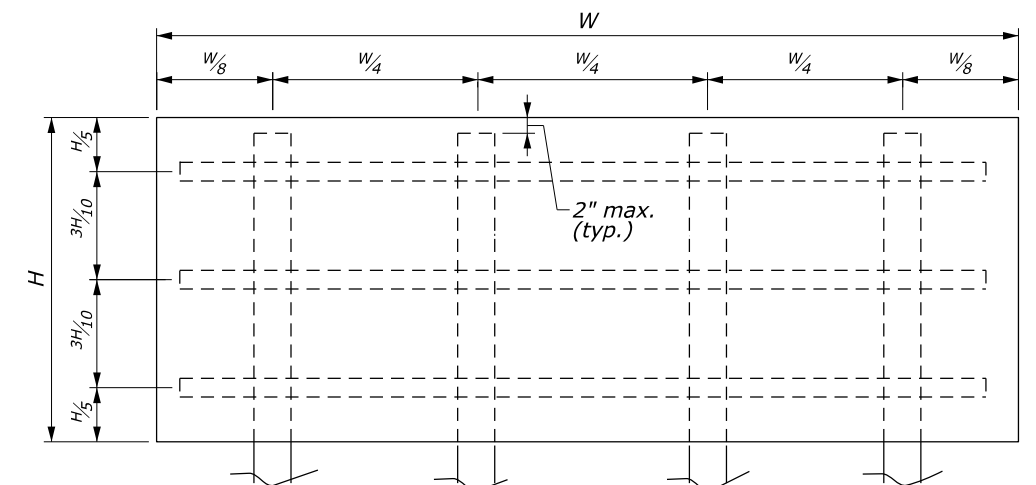

QUADRUPLE POST

**NOTES:**

1. Locate and set sign height according to the "Manual on Uniform Traffic Control Devices" (MUTCD), latest edition.
2. For U-channel, square tubular, and corrosion resistant steel posts for which the sign panel area is 10 square feet or less but W is over 4 feet, use double posts.
3. For square tubular steel double posts for which the sign panel area is equal to 24 square feet, use slip base according to manufacturer's recommendations.
4. Refer to Detail E633-02 for breakaway support details for corrosion resistant steel posts.
5. Refer to Detail E633-03 for breakaway support details for wood, U-channel steel and square tubular steel posts.
6. Refer to Detail E633-04 for bracing details for wood, U-channel steel and square tubular steel posts.
7. Refer to Section 2A.18 of the MUTCD, latest edition, for additional information.

**POST SIZE TABLE**

POST TYPE	POST SIZE	MAXIMUM SIGN AREA (SQFT)			
		SINGLE POST	DOUBLE POST	TRIPLE POST	QUADRUPLE POST
Wood	4" x 4"	10	20		
	4" x 6"	15	35	45	60
	6" x 6"	20	50	75	100
U-Channel Steel		10*	24	30	
Square Tubular Steel	2" 12 ga.	10*	16		
	2" 12 ga.	10*	24**		
Corrosion Resistant Steel	2" x 2" 10 ga. Class B	10*	24		

\* See Note 2  
\*\* See Note 3

NO SCALE

U.S. DEPARTMENT OF TRANSPORTATION, FHWA  
OFFICE OF FEDERAL LANDS HIGHWAY

**SIGN STRUCTURES**

EFLHD DETAIL  
E633-01

SPECIFICATION  
FP-24, FP-14

APPROVED FOR USE  
06/2024