

Show NPS PMIS and drawing numbers for all NPS projects (See A/E title sheet for example)

PROJECT	SHEET NUMBER
PROJECT NUMBER	A5
PROJECT NAME	

Use element template Annotation>General>Plan notes feet

Use element template Annotation>General **Heading**

See 15A.3 in the FLH ORD manual

https://highways.dot.gov/sites/fhwa.dot.gov/files/docs/federal-lands/cadd-support/ord-user-manual/36026/ord-manual15-annotations_2.pdf

Potential items to show on the site map include: horizontal alignment; project limits (bid schedules); site work; landmarks (significant planimetric features); material sources; staging areas; disposal sites; water sources; off site mitigation areas; hot plant site; environmentally sensitive areas; etc.

Potential R/W information to show on the site map include: Section lines; property boundaries; ownerships

Label names of major roads

Show limits of bid schedules

Show north arrow and appropriate scale

Refer to CFL policy on Sealing and Signing of A/E Documents (located on the FLH website):

<https://highways.dot.gov/sites/fhwa.dot.gov/files/docs/federal-lands/pm/30091/sealing-signing-policy.pdf>

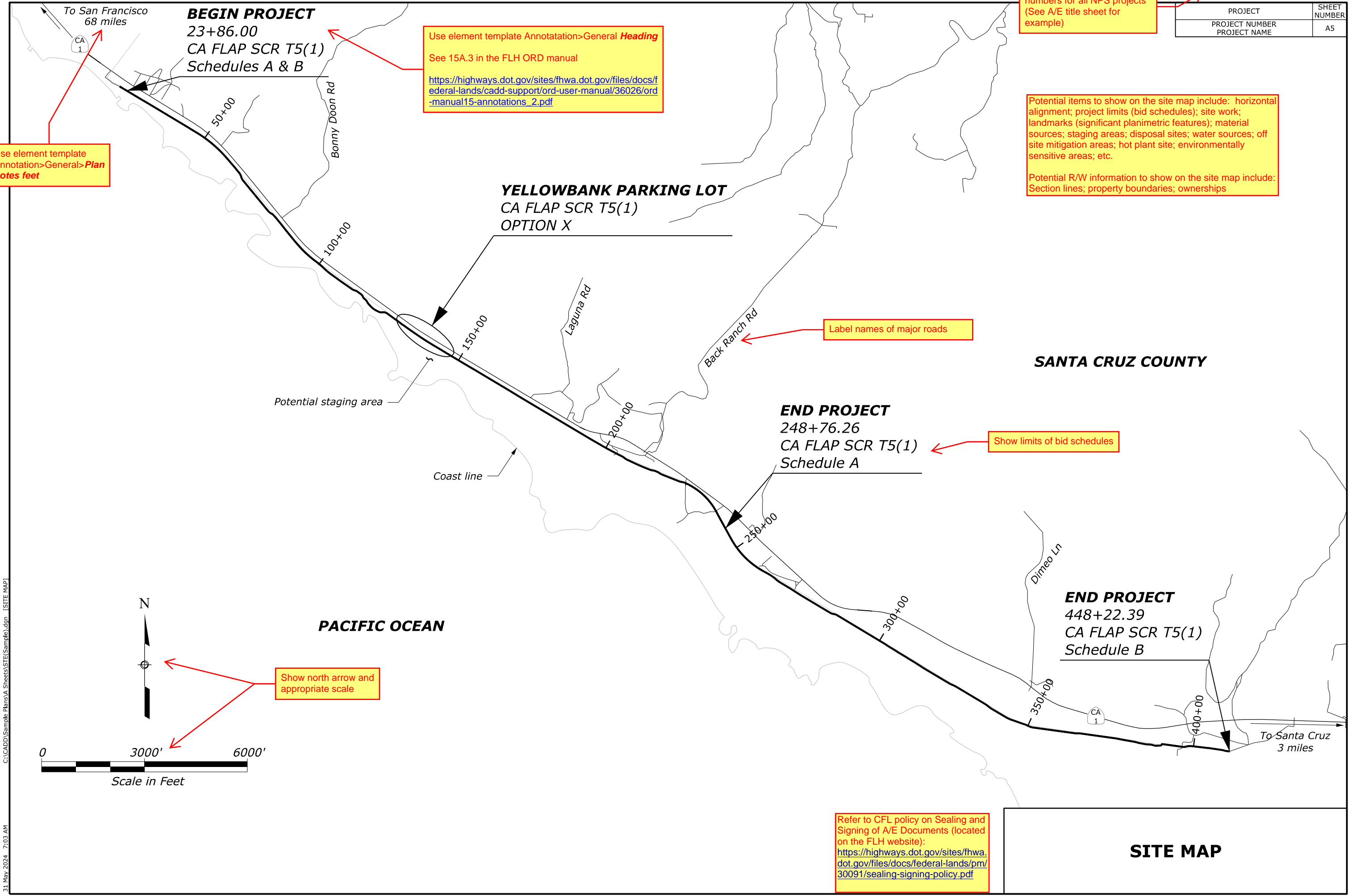

SANTA CRUZ COUNTY

PACIFIC OCEAN

SITE MAP

C:\CADD\Sample Plans\A_Sheets\SITE\Sample.dgn [SITE MAP] 31 May 2024 7:03 AM